

# Timothy Palmer

## The Nestor of American Bridge Builders

By F. E. Griggs, Jr.

Palmer, the first American long span wooden bridge builder, was born in Rowley, Massachusetts on August 22, 1751. He married Anna Wyatt on December 16, 1776 in Newburyport. She died in 1786. He later married Hannah Downer on March 9, 1795. He had no children from either marriage.



Timothy Palmer 1751 – 1823

Early in life Palmer was apprenticed to Daniel Spofford, a leading local architect and millwright, who was involved in the design and construction of many churches/meeting houses in the area. Palmer was one of the local minutemen who marched to Concord on April 16, 1775 and later served three months in the local militia. His main



Essex Merrimack Bridge 1792 Looking East

action was the Battle of Bunker Hill in June 1775. After the war, he continued his architect activities designing several meetinghouses.

In 1791, he took an entirely new path and designed a major bridge to cross the Merrimack River just west of the village of Newburyport. An island existed in the river; to address the demands of river traffic, Palmer needed a long span truss over the branch of the river between the southerly bank and the island. Without any local precedent he designed a highly cambered long span (160-foot) truss that resembled, but was an improvement on, a pattern developed by Andreas Palladio in the mid 16<sup>th</sup> Century in Italy.

He used the same truss pattern with structures over the Merrimack River at Andover, Haverhill, and Rocks Village. His next innovation was a bridge across

“Great Bay of the Piscataqua River” (the bridge is not over the Piscataqua River but over the Bay adjacent to the river). The total bridge was 2,360 feet long and 38-feet wide. Palmer designed and built a main span over the navigable channel of 244 feet. The water at the bridge site was about 52-feet deep, thus requiring major falsework. Prior to this he had the deck resting on the bottom chord of the truss with overhead bracing. At Piscataqua he introduced another tier of timber located near the top of the truss on which the deck was placed and put bracing under the deck. His top chord, in addition to its contribution to the truss, was also the bridge railing. He ordered timbers up to 16 x 18-inches in section, over 50-feet long with a natural curvature to match the curvature of his three chord members. When opened in 1794 this was the longest span bridge in the world.

In 1797 he was the fourth man to be awarded a patent on a bridge. Unfortunately, as the result of a fire in the offices of the Patent Office in 1836, any record of what he had patented was lost. It is likely, however, that the bridge would be very much like the bridge he built across the Potomac River at Little Falls.

He also built bridges over the Kennebec River near present Augusta, Maine and over the Connecticut River at Windsor-Cornish. He was called to Philadelphia in 1803 to build a bridge over the Schuylkill River. The bridge company had started to place two abutments and two river piers in very difficult conditions. With the final design of the bridge still undetermined, the Company asked Palmer to design and build a wooden structure that would be

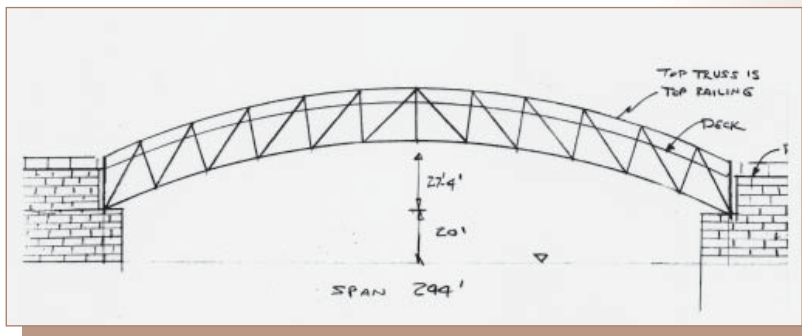

Piscataqua Bridge December 1794



Piscataqua Bridge, Gilmor Sketch (modified to show truss members)

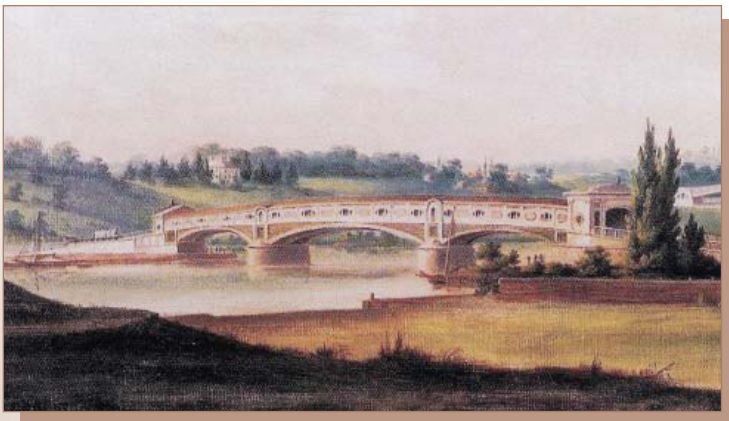

*Permanent Bridge with Covering and Tollhouse Portals (Painting by William Strickland 1815)*

inexpensive, as they had already spent a great deal of money on the masonry work. Palmer designed a three span structure with side spans of 150-feet and a central span of 195-feet.

It was called the Permanent Bridge, as it replaced a floating bridge that had to be taken up in times of flood or ice flow. When it was nearing completion,

following year by another builder. The bridge survived until 1850 when it was replaced by another with a horizontal deck enabling it to carry railroad traffic as well as carriage and pedestrian traffic.

Palmer's last major structure was a bridge over the Delaware River connecting Easton, Pennsylvania with Philipsburg, New Jersey. The bridge company

Bridge, and he moved his crew directly from Philadelphia to Easton to build it. For the first time his middle truss did not run to the roof of the bridge. Instead he had the deck sit on top of the central truss, while his side trusses ran to the roof. This bridge lasted until 1895, surviving many floods common to the Delaware River.

With the completion of the Easton Bridge, Palmer returned to Newburyport where he was Surveyor of Highways from 1800 to his death in 1823. He submitted designs for the successor to his Haverhill Bridge and consulted on several other projects while also serving as the local agent for James Finley and his chain suspension bridges. His linkage with Finley began when the 160' span of his Essex Merrimack Bridge was replaced with a chain bridge in 1812. Palmer's work convinced many that he indeed was the "Nestor of American Bridge Builders". ■

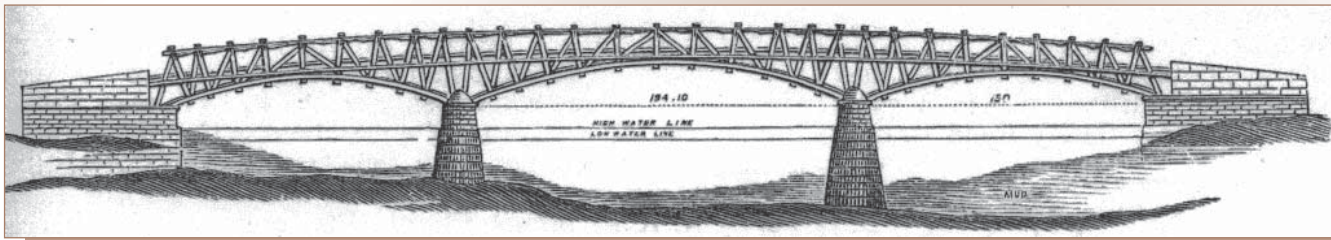

*Permanent Bridge – Structure*

Judge Richard Peters, leader of the bridge committee, suggested that it be covered to protect the investment of the stockholders. Palmer, who had recommended covering some of his earlier bridges, agreed and modified the structure to receive a roof and siding, making this the first covered bridge in the country. The bridge opened on January 1, 1805 without the roof or siding that was designed and added in the

started this bridge in the late 1790s, but had financial and technical difficulties. Palmer was called to the project about the same time he was awarded the Permanent Bridge contract. He gave them a design for three spans fitting the requirements of the abutments and piers then in the process of being completed. Span lengths ranged from 155-feet to nearly 160-feet. The design was similar to his Schuylkill

*Dr. Griggs specializes in the restoration of historic bridges, having restored many 19th century cast and wrought iron bridges. He was formerly Director of Historic Bridge Programs for Clough, Harbour & Associates LLP in Albany NY and is now an independent Consulting Engineer.*

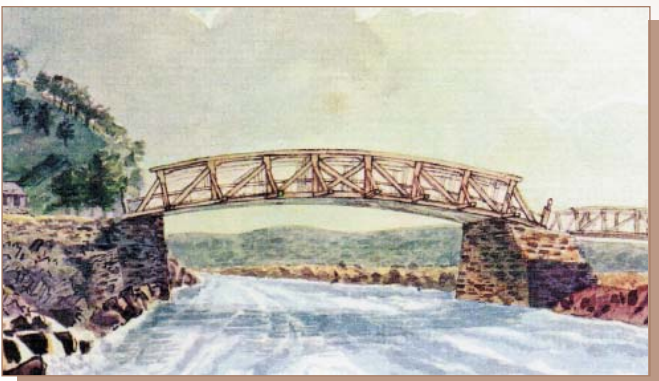

*Potomac River Bridge at Little Falls (Painting by Benjamin H. Latrobe)*

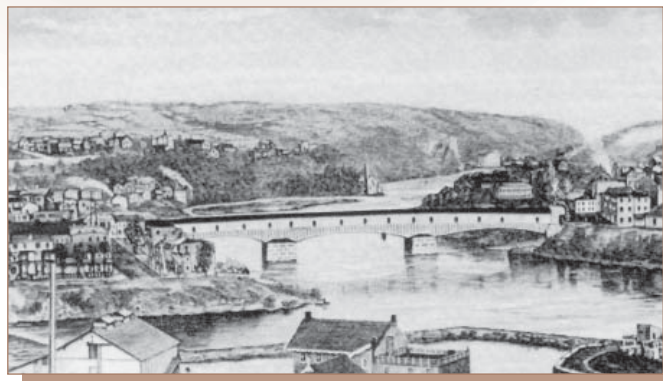

*Easton Bridge 1806-1895*